

AHP-85MB & AHP-85MB-C HANDPIECES

IRRIGATION TUBING SETUP GUIDE

This guide provides step-by-step instructions for installing internal and external irrigation tubing onto the AHP-85MB and AHP-85MB-C Mont Blanc® contra angle handpieces.

(NOTE: AHP-85MB handpiece shown.)

Step 1: Remove Mont Blanc® handpiece (see Figure 1, Item #1) from box and install onto dental motor (consult motor operator's instructions). Insert rotating instrument into head of handpiece until "click" is heard.

Step 2: Preassemble Items #2, #3, #4, and #5 into a subassembly, as shown in Figure 2.

Step 3: Mount subassembly from Step 2 onto handpiece/motor, as shown in Figure 3.

Step 4: Connect tubing components with tubing from irrigation pump, as shown in Figure 3.

Single-Irrigation Setup: To set up irrigation for either internal only, or external only, connect the tubing w/small ID directly to the desired internal or external port — do not use the "Y" connector. See Figure 4.

NOTE: When tubing is set up for simultaneous internal/external irrigation (Figure 3), the irrigation fluid will favor the line of least resistance, so the bulk of the fluid will flow to the external port.

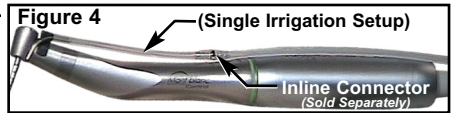
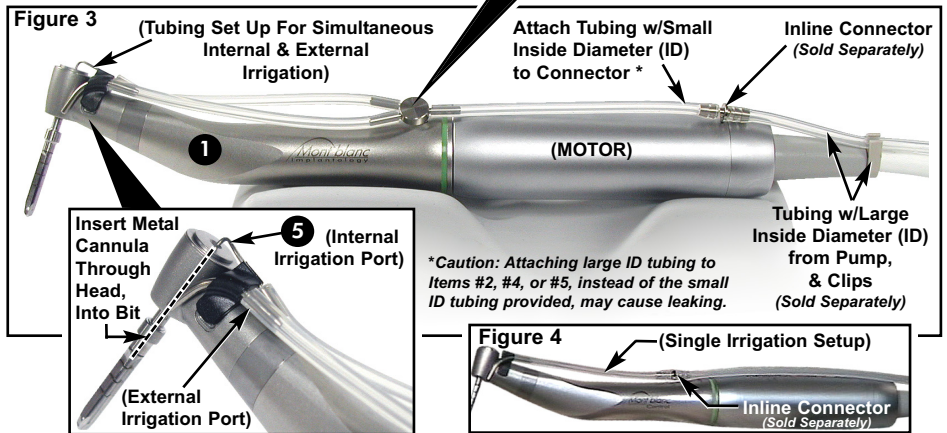
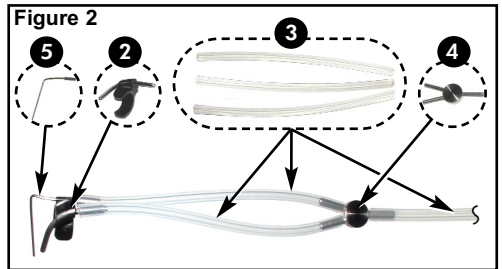

8333 216th Street SE
Woodinville, WA 98072
Phone: 425-487-3157 • www.aseptico.com
P/N: 420744 Rev. B ECO 11799 04/2008